



South Park Hill Road, South Croydon, CR2 7DW

£1,700 PCM



# South Park Hill Road, South Croydon, CR2 7DW

£1,700 PCM



Arranged over the first and second floors, the property benefits from a bright and practical layout. The first floor comprises a generous reception room overlooking the gardens to the rear, together with a good sized kitchen/breakfast room to the front.

Arranged over the first and second floors, the property benefits from a bright and practical layout. The first floor comprises a generous reception room overlooking the gardens to the rear, together with a good sized kitchen/breakfast room to the front. The kitchen is fitted with a gas hob, electric oven, fridge / freezer, washing machine and dishwasher.

The second floor provides two double bedrooms, both with built-in wardrobes, along with a family bathroom. The property also benefits from excellent storage throughout.

The property is currently being redecorated throughout and will benefit from new flooring in the kitchen, together with new blinds in the bathroom and second bedroom.

Externally, there is a private south facing garden, ideal for enjoying the afternoon and evening sun, as well as access to the communal grounds.

Private garage available by separate negotiation, ideal for secure parking, bicycles or additional storage.

Hobart Court is ideally positioned on South Park Hill Road, approximately 0.4 miles from South Croydon Station, providing regular services into London Bridge,

Victoria and Gatwick Airport. Local shops, bus routes and everyday amenities are all within easy walking distance, while South Croydon's popular restaurant quarter is around 0.6 miles away.

Offered unfurnished & available immediately.

Council Tax Band: D (London Borough of Croydon)  
Holding Deposit: £392

Image disclosure: Some photographs have been digitally enhanced using AI to provide a realistic representation of the property whilst ongoing improvement works are being undertaken. Images are for guidance only. No applications or offers will be accepted without an in-person viewing of the property.



### Road Map



### Hybrid Map



### Terrain Map

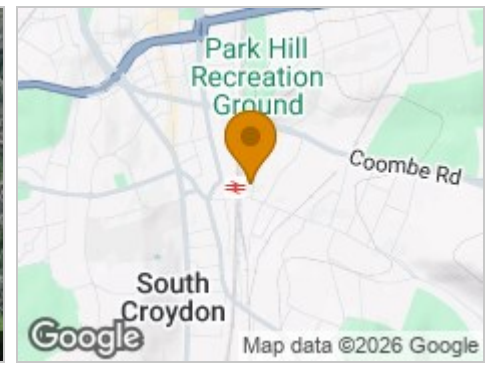

### Floor Plan

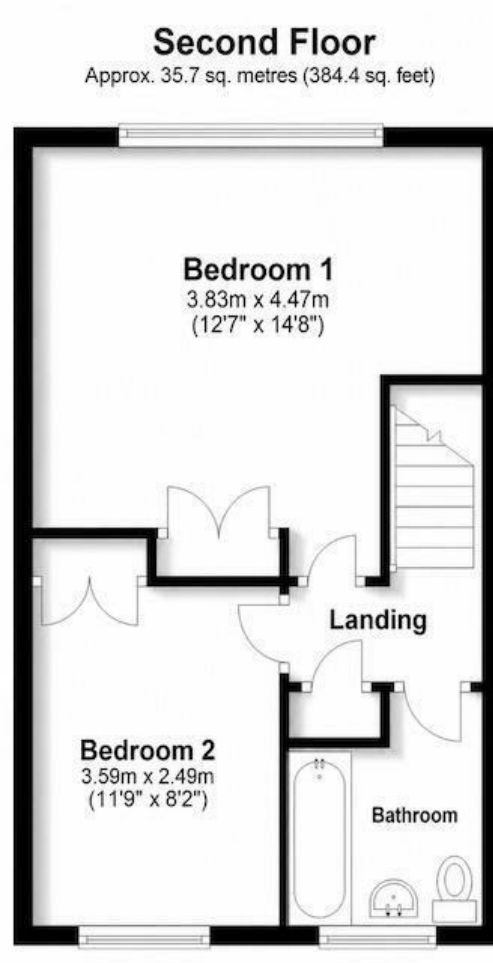
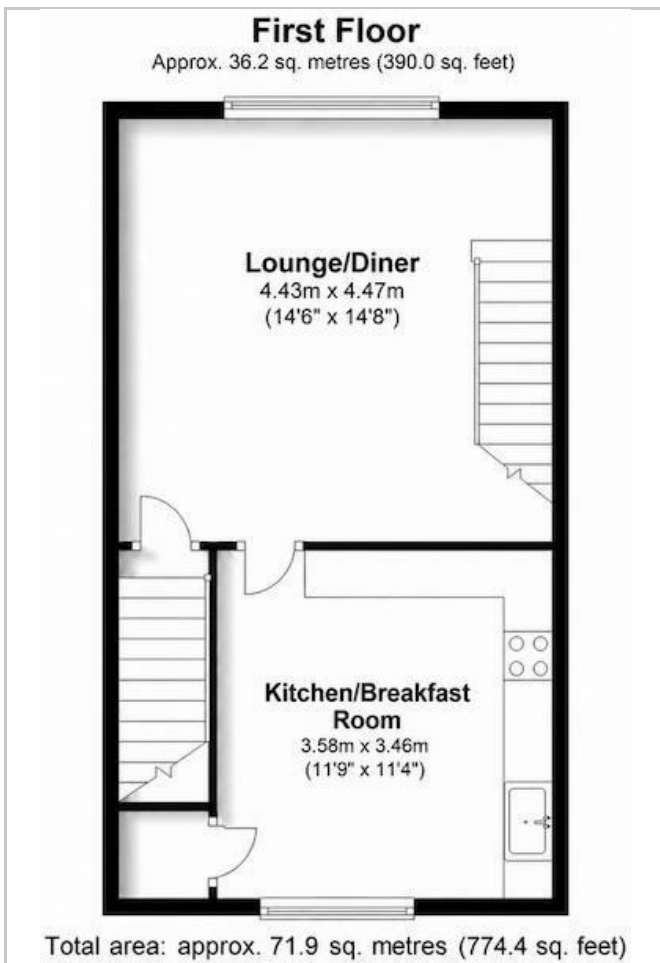

### Viewing

Please contact our Hirsch Estates Office on 020 3002 0587 if you wish to arrange a viewing appointment for this property or require further information.

### Energy Efficiency Graph

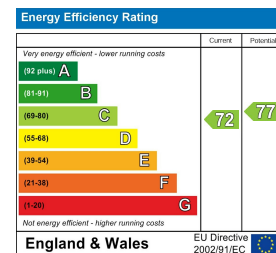

These particulars, whilst believed to be accurate are set out as a general outline only for guidance and do not constitute any part of an offer or contract. Intending purchasers should not rely on them as statements of representation of fact, but must satisfy themselves by inspection or otherwise as to their accuracy. No person in this firm's employment has the authority to make or give any representation or warranty in respect of the property.